

Schnellmontage-Scharnier mit Cliptechnik, mit sichtbarer Rolle, Fuge 4mm
 Clip-on hinge, easy assembly, with exposed axle, 4mm gap

Topfdurchmesser 35mm, zum Anschrauben
 Cup diameter 35mm, screw-on type

Bohrbild / Hole pattern: 45mm

Material: Zamak vernickelt / Zamac nickel plated

50

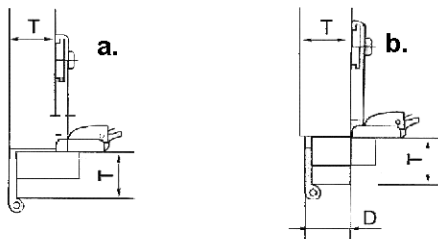

T = Türstärke / Door thickness = 14-19mm
D = Türauflage / Overlay

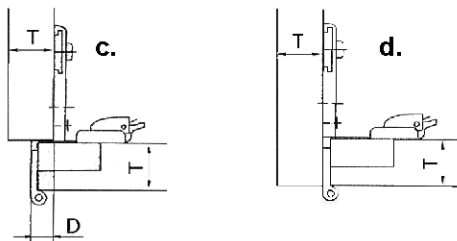

	Art. No.
a. Aufliegend / Full overlay	2700.019
b. D = 16mm	2700.016

	Art. No.
Mittelwand / Half overlay	2700.013
c. D = 9,5mm	2700.013
	Art. No.
d. Einliegend / Inlay	2700.000

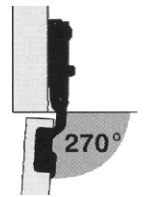
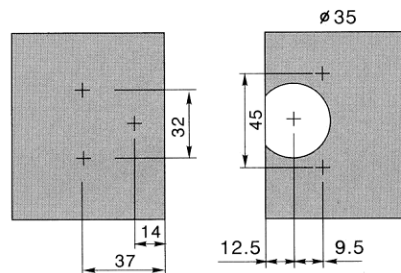
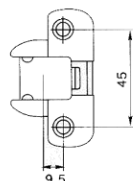
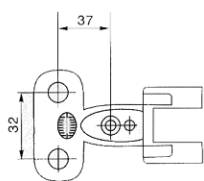
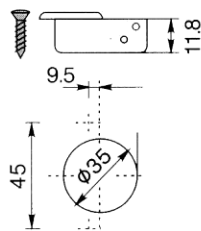

Sichtbare Rolle
 Exposed axle



Mittelwand /
 Double doors



Maßangaben unverbindlich / Dimensions not binding