

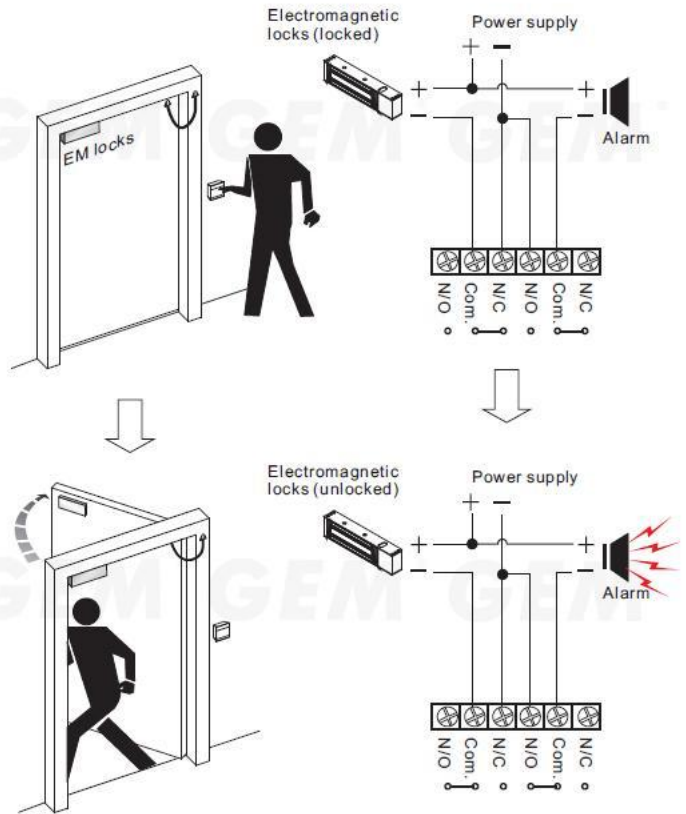

Application



Statement

The CP-22 series call point, with double pole change over contacts from N/C to N/O. The main function is to override the electrical locking/release devices in case of emergency. With Key to reset unit.

Specifications

Dimensions: 88x88x60 mm
Contact Resistance: 150m
Switch rated: 3A@125V~

No need to power in. It has a double pole switch for monitoring in case of emergency when pressed on the front face of the unit; the contacts change from N/C to N/O.

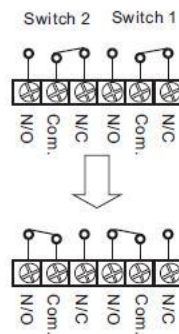

Dimension

Unit: mm
(Common Europe Sized)

