



YLI ELECTRONIC



Piezoelectric Exit Button

Model: PBS-821A(LED)

Specification

- Dimensions:114Lx70Wx16H(mm)
- Voltage:12-24V
- Current:Standby 20mA,Operation: 60mA
- Output Contact:NO/COM
- Current Rating:1A@30VDC 0.5A@125VDC
- Waterproof Level:IP-68
- LED Status: Red: Standby Green : Operation
- Wire color: Red: Positive Black: Negative
White: NO/COM Blue: SET Terminal for switch mode (Nouse Default, if need self-lock mode, please connect SET Terminal to Negative of Power)
- Optional Colors: Silver ;Golden(can be customized)
- Weight:0.12kg

Installation & Size

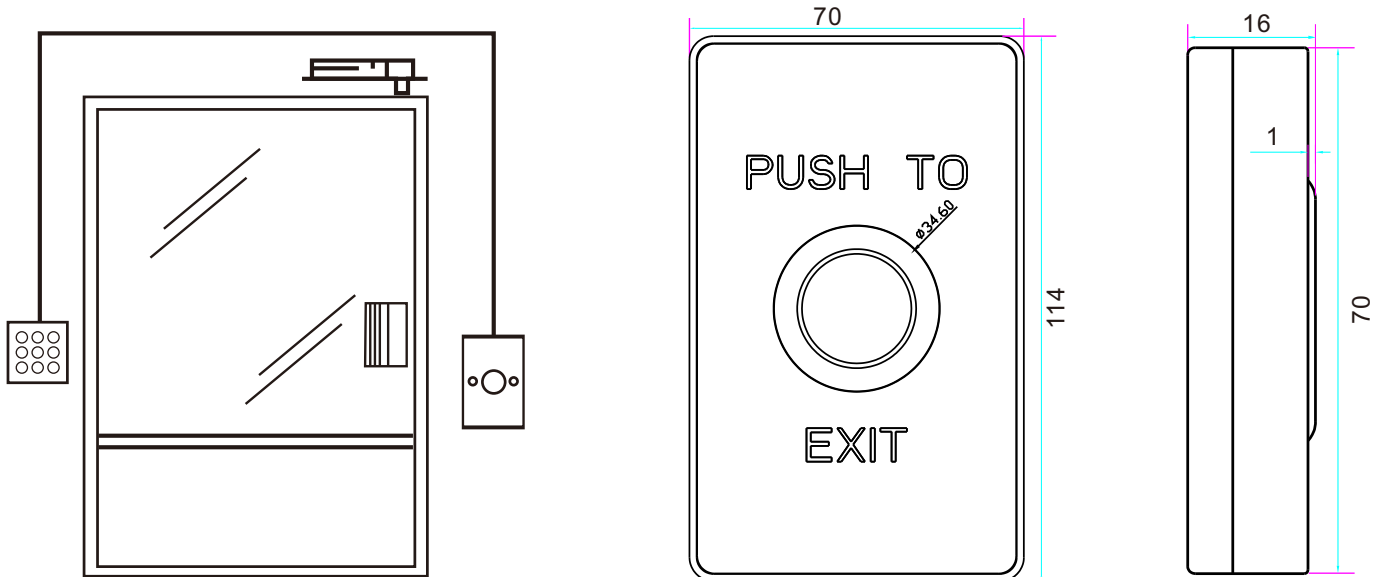

Wiring Diagram

- ☐ — Red — — + 12V DC
- ☐ — Black — — —
- ☐ — White — — } NO COM
- ☐ — White — — }
- ☐ — Blue — — SET Terminal for switch mode(Nouse Default, if need self-lock mode, please connect SET Terminal to Negative of Power)