



YLI ELECTRONIC



Piezoelectric Exit Button(Stainless)

Model: PBS-820C

Specification

- Dimensions:86Lx86Wx20H(mm)
- Directly dry contact input, no external power supply
- Current:Standby 20mA
- Output Contact:NO/COM
- Current Rating:1A @ 12VDC(Max)
- Waterproof Level:IP-68
- Contact Area:<100ohm
- Operating Temperature: -20°C ~50°C
- Operating Humidity: 0%~99%
- Wire color: White: NO/COM
- Normally Open Contact:(as shown)
- Weight:0.2kg

Installation & Size

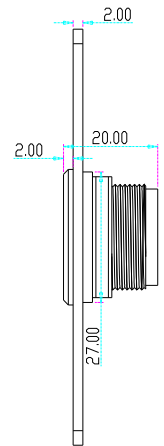
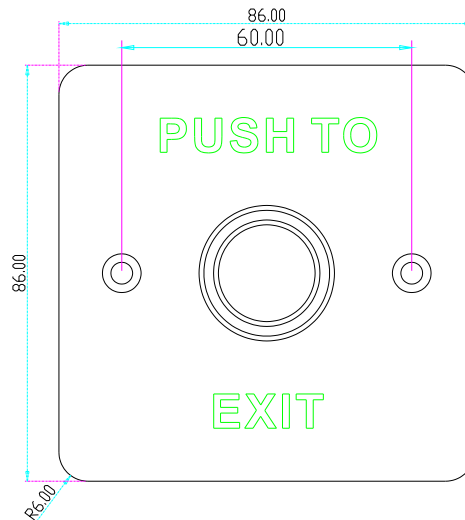
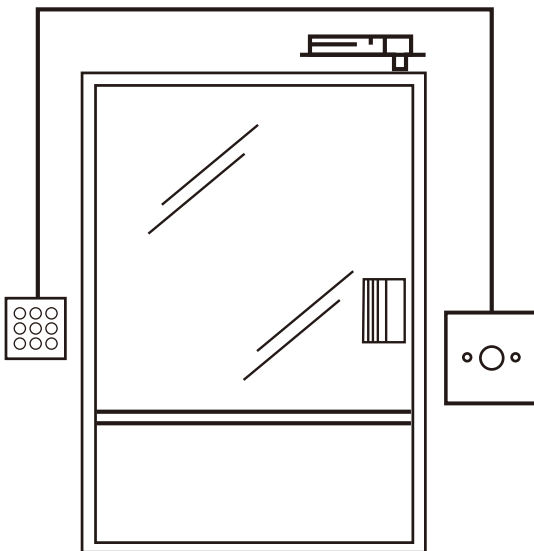

Wiring Diagram

