

Mit Schließblech
With striking plate

Dornmaß / Backset: 25mm

Material: Zamak vernickelt /
Zinc alloy nickel plated

20

Art. No.

Lad / Drawer

1051.100

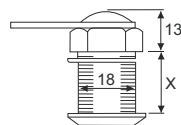
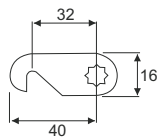

Mit Haken - Schließhebel, 90° Schließweg
With hook lever, 90° locking travel

Material:

Schloss / Lock: Zamak, vernickelt / Zinc alloy, nickel plated

Schließriegel / Lever: Stahl, chromatiert / Steel galvanised

20

Schließweg

Closure travel

X =

Art. No.

A(D,F,G) 17mm **1131.300.24**

A(D,F,G) 22mm **1141.300.24**

A(D,F,G) 30mm **1141.000.24**

